

Price includes standard floorplan with S1 facade.



FIRST HOME BUYERS PRICE \$564,747 ^

FIXED PRICE HOUSE & LAND

VIVA1-13

Lot 108, Serene Avenue

LAND SIZE: 294.00m²



126.62m² | 13.63 sqs

- ✓ Council and Developer Requirements
- ✓ 25 Year Structural Guarantee
- ✓ \$888 Deposit
- ✓ Stone bench tops & overhead cupboards to the kitchen
- ✓ 900mm appliances & dishwasher to the kitchen
- ✓ Tiled Shower Bases
- ✓ Choice of tiles or timber look laminate flooring
- ✓ Driveway & Garage door remotes
- ✓ Double glazed windows

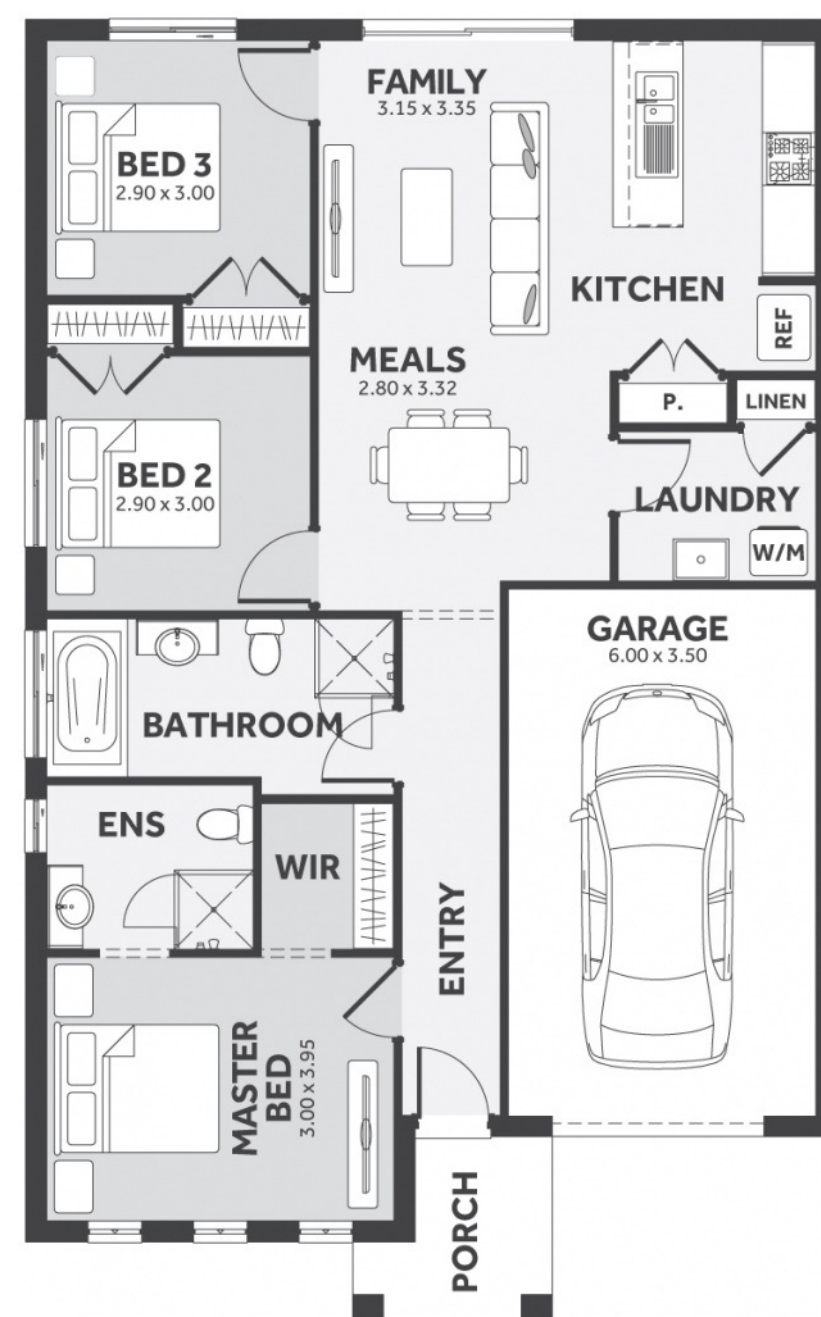

Please Contact
Paige McCarthy
0404 209 118
paigem@8homes.com.au

We make it easy!