

Price includes standard floorplan with S1 facade.



Furniture, feature lighting, landscaping, driveway, window furnishings, and porch decking not provided by Eight Homes.

FIRST HOME BUYERS PRICE \$708,840 ^

FIXED PRICE HOUSE & LAND

S TWO.2

Lot 128, Waterfern Street

LAND SIZE: 392.00m²

Taylors
Run

4 2.0 2

182.36m² | 19.63 sqs

- ✓ Council and Developer Requirements
- ✓ 25 Year Structural Guarantee
- ✓ \$888 Deposit
- ✓ Stone bench tops & overhead cupboards to the kitchen
- ✓ 900mm appliances & dishwasher to the kitchen
- ✓ Tiled Shower Bases
- ✓ Choice of tiles or timber look laminate flooring
- ✓ Driveway & Garage door remotes

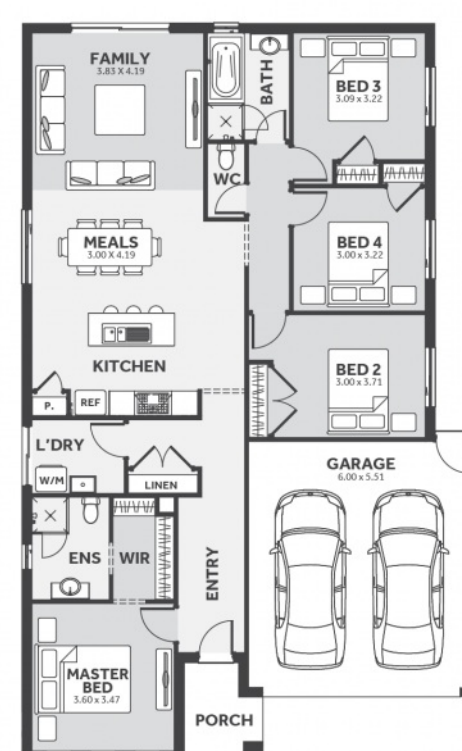

Please Contact

Tony Cursaro

0481 294 133

tonyc@8homes.com.au

We make it easy!

