

Price includes standard floorplan with S1 facade.



Furniture, feature lighting, landscaping, driveway, window furnishings, and porch decking not provided by Eight Homes.

FIRST HOME BUYERS PRICE \$654,464 ^

FIXED PRICE HOUSE & LAND

S TWO.2

Lot 2251, Villa Doria Drive
LAND SIZE: 349.00m²

SMITHS LANE

4 2.0 2

182.36m² | 19.63 sqs

- ✓ Council and Developer Requirements
- ✓ 25 Year Structural Guarantee
- ✓ \$888 Initial Deposit for the home only
- ✓ Quantum Zero Benchtop & Overhead Cupboards to Kitchen
- ✓ 900mm Appliances & Dishwasher to Kitchen
- ✓ Tiled Shower Bases
- ✓ Choice of Tiles or Timber-look Laminate Flooring
- ✓ Double Glazed Windows ‡

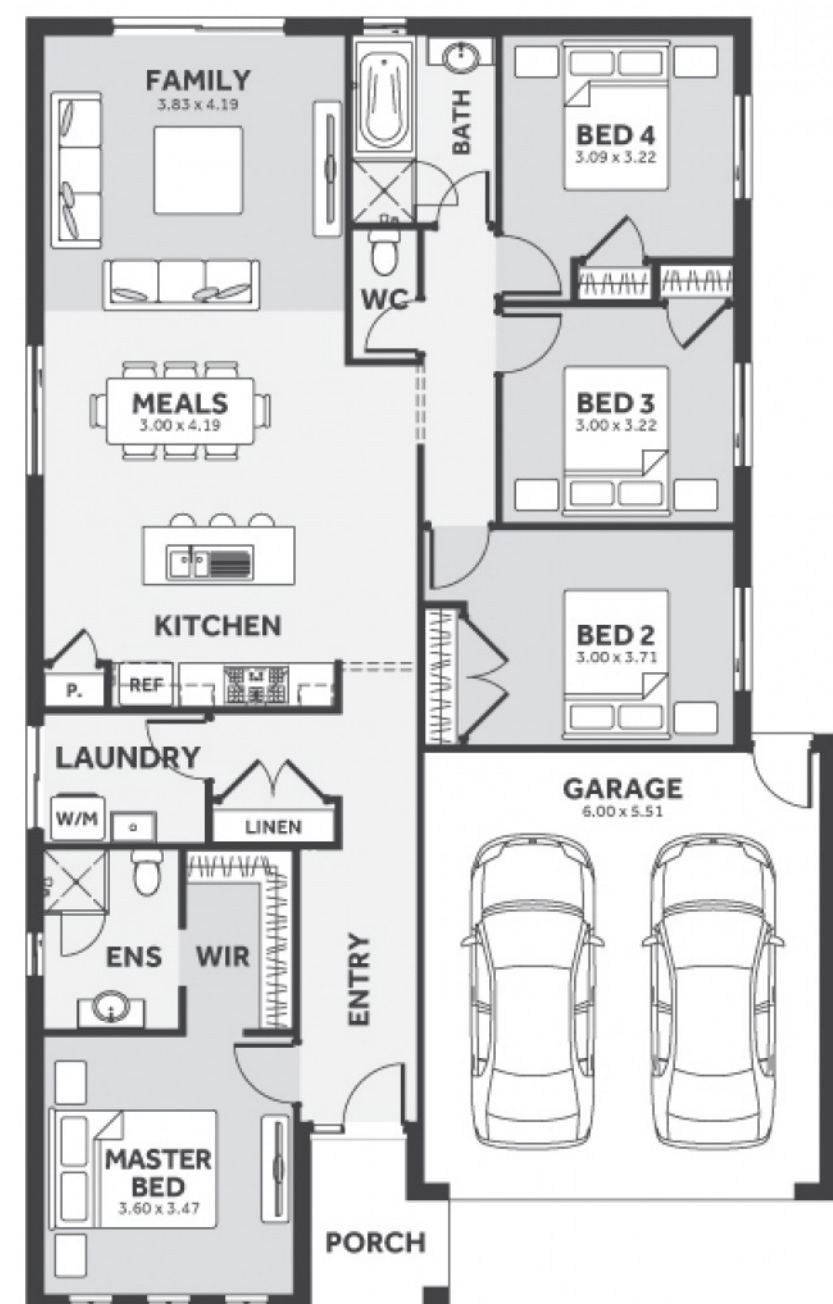

Please Contact
Chloe Amolo
0425 809 385
chloea@8homes.com.au

We make it easy!