

Price includes standard floorplan with S1 facade.



Furniture, feature lighting, landscaping, driveway, window furnishings, and porch decking not provided by Eight Homes.

FIRST HOME BUYERS PRICE \$565,997

## FIXED PRICE HOUSE & LAND

**d ONE.1**

Lot 1910, Jukes Mews  
LAND SIZE: 294.00m<sup>2</sup>



232.9m<sup>2</sup> | 25.07 sqs

- ✓ Council and Developer Requirements
- ✓ 12 Month Price Freeze
- ✓ 25 Year Structural Guarantee
- ✓ \$888 Deposit
- ✓ Efficient and Simple
- ✓ Stone bench tops & 900mm appliances to Kitchen
- ✓ Stylish 8mm timber look laminate flooring
- ✓ Driveway

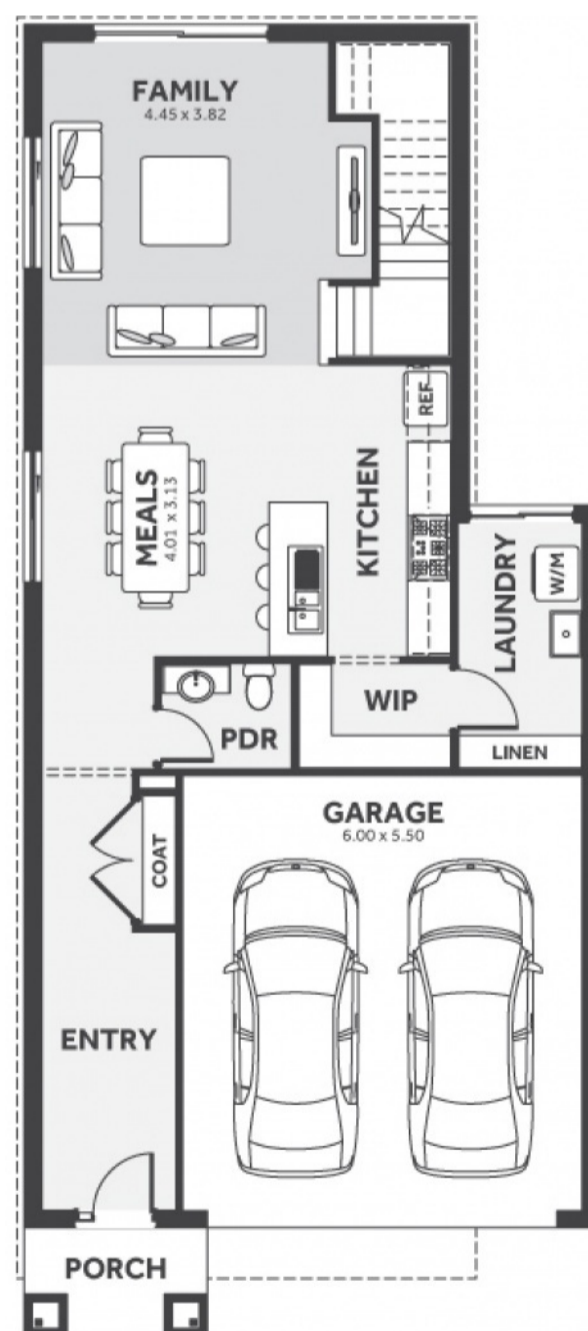

Please Contact  
Harry Singh  
0493 222 303  
harrys@8homes.com.au

*We make it easy!*

