

Price includes standard floorplan with S1 facade.



FIXED PRICE HOUSE & LAND

VIVA1-13

Lot 1519, Skeleton Ave
LAND SIZE: 263.00m²

Grandview

3 2.0 1

126.62m² | 13.63 sqs

- ✓ Council and Developer Requirements
- ✓ 25 Year Structural Guarantee
- ✓ \$888 Deposit
- ✓ Stone bench tops & overhead cupboards to the kitchen
- ✓ 900mm appliances & dishwasher to the kitchen
- ✓ Tiled Shower Bases
- ✓ Choice of tiles or timber look laminate flooring
- ✓ Driveway & Garage door remotes

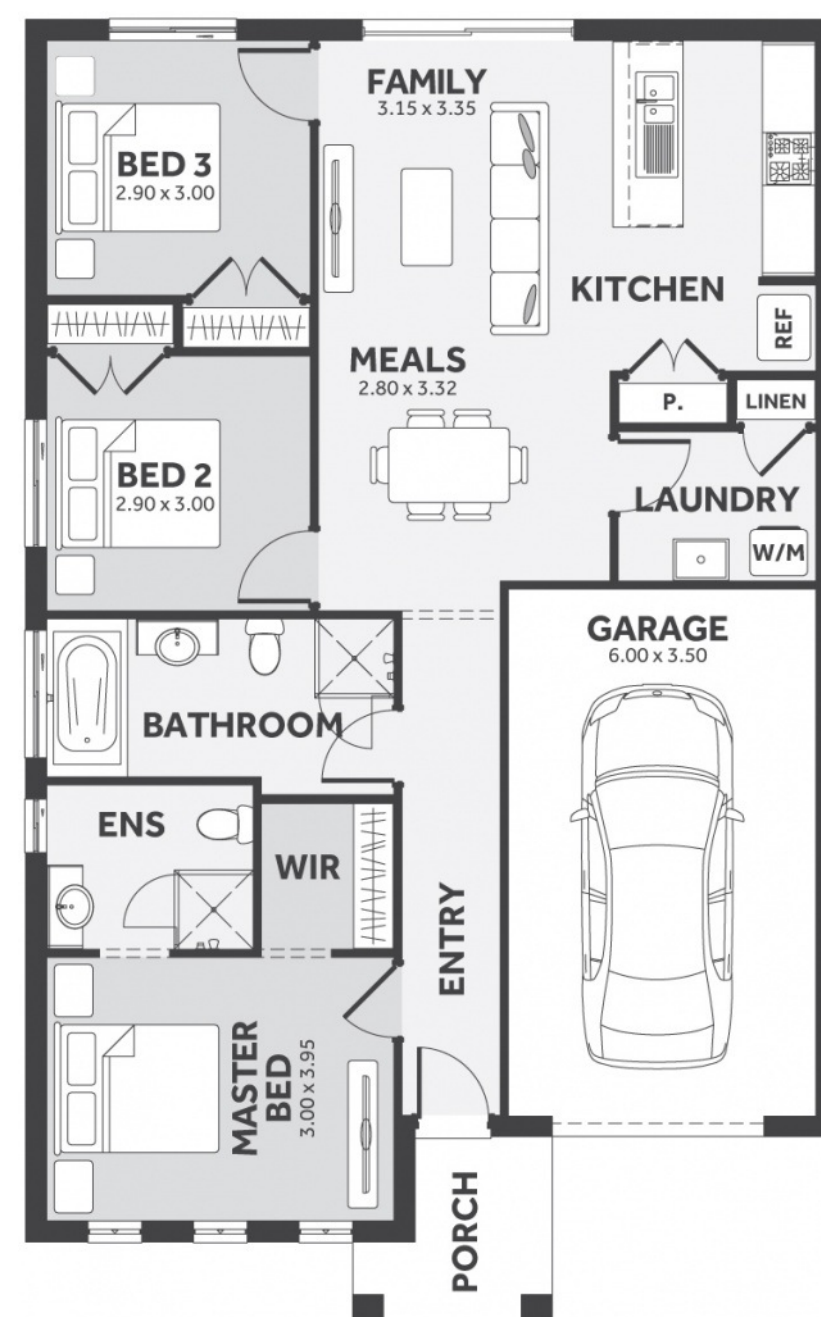

Please Contact
Billy Spaseski
0451 985 551
Billys@8homes.com.au

We make it easy!