

Price includes standard floorplan with S1 facade.



FIRST HOME BUYERS PRICE \$522,459 ^

## FIXED PRICE HOUSE & LAND

## VIVA1-13

Lot 2326, Cassia Way Mickleham  
LAND SIZE: 221.00m<sup>2</sup>



126.62m<sup>2</sup> | 13.63 sqs

- ✓ Council and Developer Requirements
- ✓ 25 Year Structural Guarantee
- ✓ \$888 Deposit
- ✓ Stone bench tops & overhead cupboards to the kitchen
- ✓ 900mm appliances & dishwasher to the kitchen
- ✓ Tiled Shower Bases
- ✓ Choice of tiles or timber look laminate flooring
- ✓ Driveway & Garage door remotes

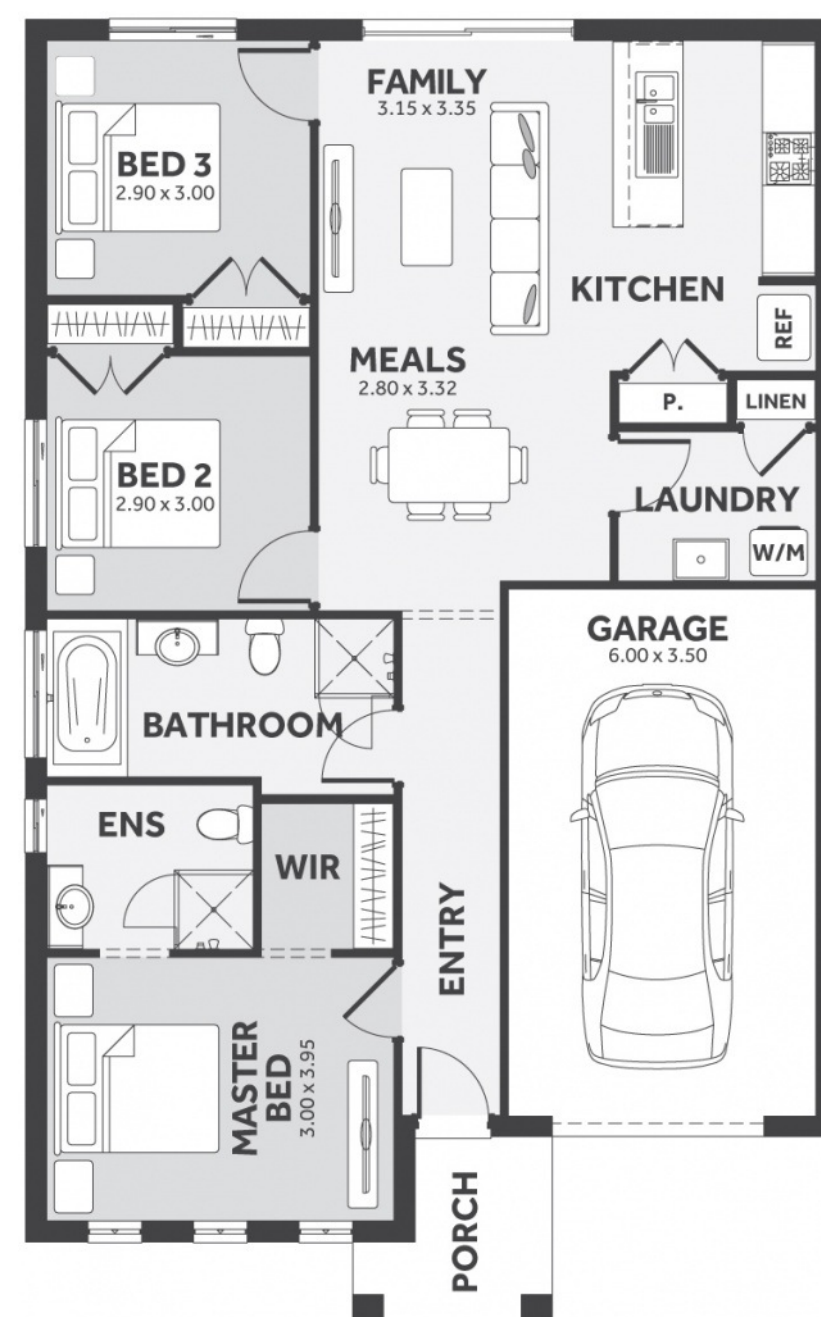

Please Contact  
Cindy Lu  
0400 914 373  
cindyl@8homes.com.au

*We make it easy!*