

Price includes standard floorplan with S1 facade.



FIRST HOME BUYERS PRICE \$494,222 ^

FIXED PRICE HOUSE & LAND

VIVA1-15

Lot 1221, Abbeygate Dve Cornerstone
LAND SIZE: 274.00m²

CORNER
STONE
WERRIBEE

3 2.0 1

140.46m² | 15.12 sqs

- ✓ Council and Developer Requirements
- ✓ 25 Year Structural Guarantee
- ✓ \$888 Deposit
- ✓ Stone bench tops & overhead cupboards to the kitchen
- ✓ 900mm appliances & dishwasher to the kitchen
- ✓ Tiled Shower Bases
- ✓ Choice of tiles or timber look laminate flooring
- ✓ Driveway & Garage door remotes

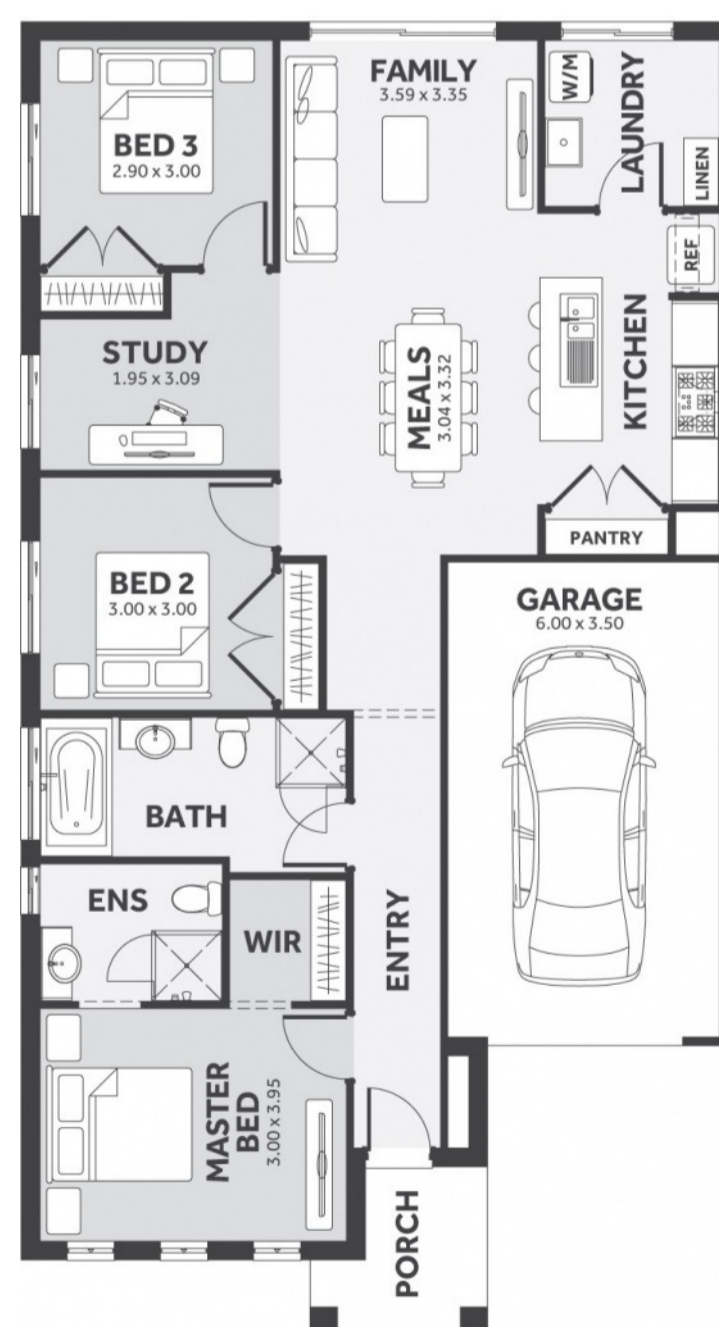

Please Contact
Marisa Robbins
0409 173 264
marisar@8homes.com.au

We make it easy!