

Price includes standard floorplan with S1 facade.



FIRST HOME BUYERS PRICE \$639,342 ^

FIXED PRICE HOUSE & LAND

S ONE.3

Lot 903, LANDOVER ROAD

LAND SIZE: 321.00m²

ellery
at wollert

3 2.0 1

137.49m² | 14.80 sqs

- ✓ Council and Developer Requirements
- ✓ 25 Year Structural Guarantee
- ✓ \$888 Deposit
- ✓ Stone bench tops & overhead cupboards to the kitchen
- ✓ 900mm appliances & dishwasher to the kitchen
- ✓ Tiled Shower Bases
- ✓ Choice of tiles or timber look laminate flooring
- ✓ Driveway & Garage door remotes
- ✓ Double glazed windows

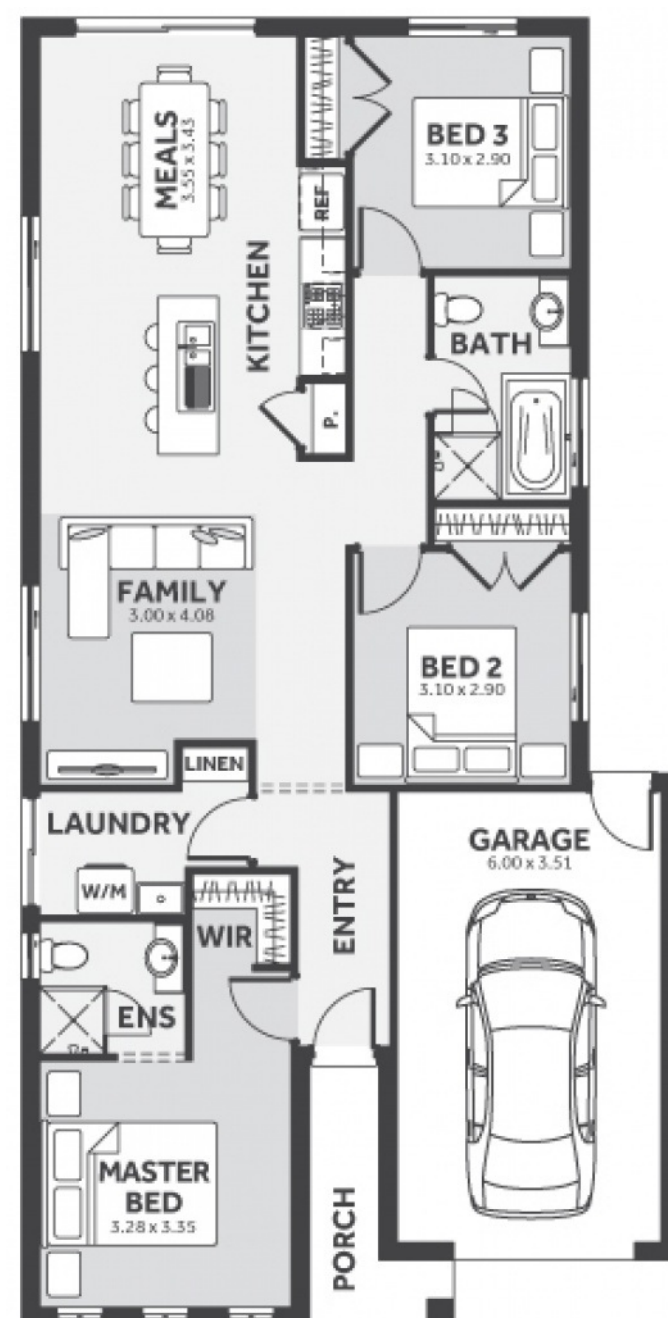

Please Contact

Kathy Salva

0417 571 005

kathys@8homes.com.au

We make it easy!